



# JOSAM i-press

A universal straightening system  
for heavy vehicles





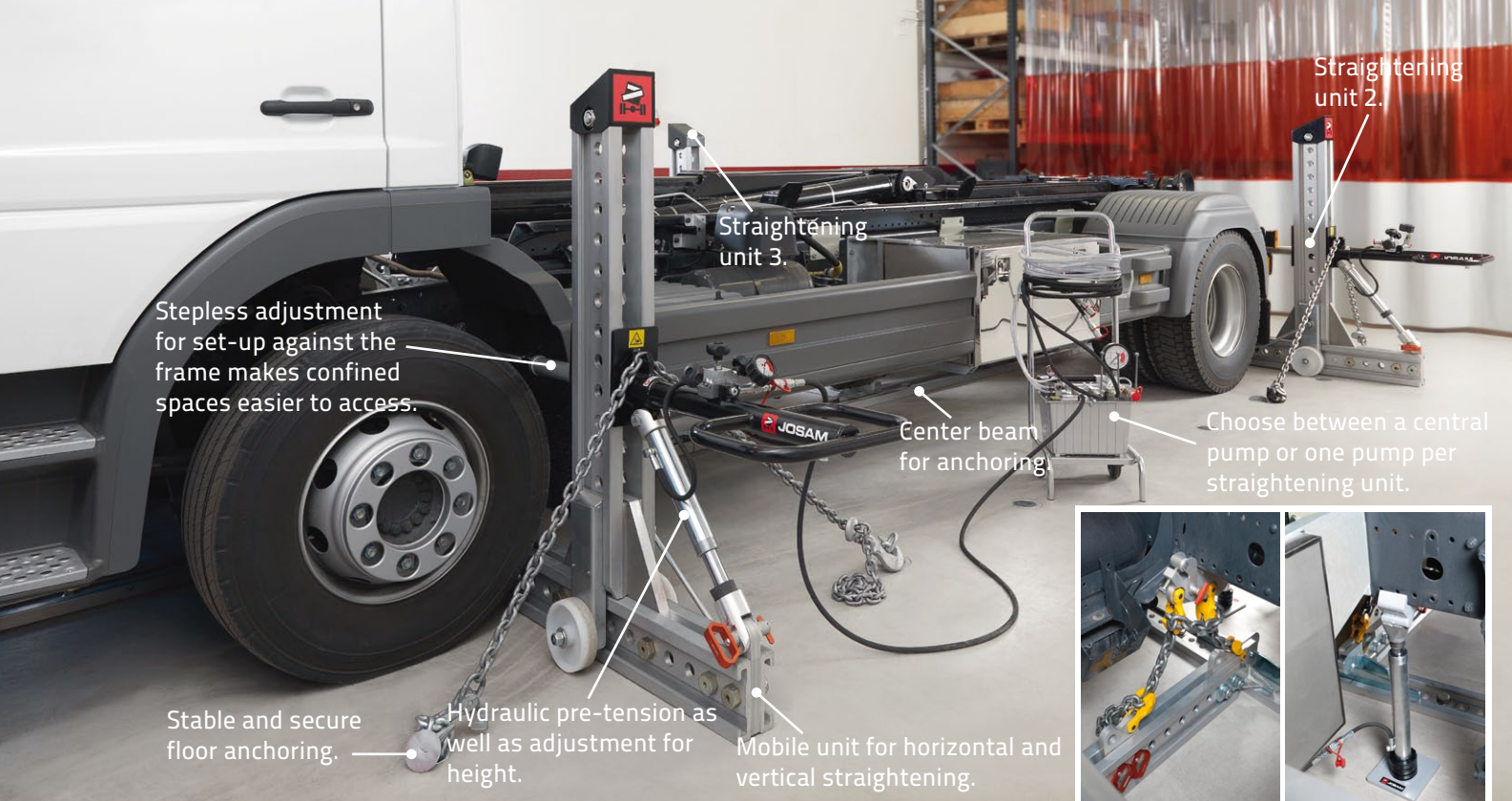

## Here is how the JOSAM i-press works

The system consists of three complete straightening units each mounted on wheels and with accessories. It can easily be complemented with other Josam straightening tools such as our C-clamps and hydraulics.

The JOSAM i-press has a unique capacity. The three multi-functional straightening units work in X-, Y- and Z- directions and can press and withstand pressure both in a horizontal and vertical direction. The equipment is ergonomic, easy to handle and is moved with a stable handgrip.

The JOSAM i-press is made of aluminium alloy. The low weight makes installation and handling easier. Minimal set-up time. When you take hold of the handgrip, you take with you the complete straightening unit. The force is distributed through several floor anchorings. The pre-tension makes it possible for a variable set-up.

When the straightening system is not being used, wheel it over to the side and the floor area is free to use for other work. The JOSAM i-press is optimal for use on a floor surface area of approximately 4 X 14 meters. The system is flexible and if the facility is longer than 14 meters, the workplace can simply be prolonged. It is safe to use.

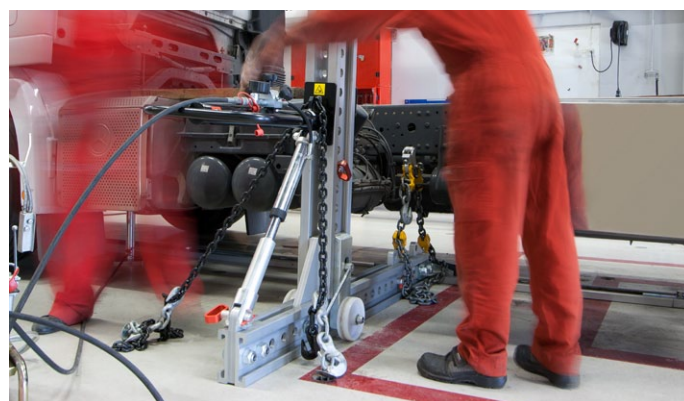



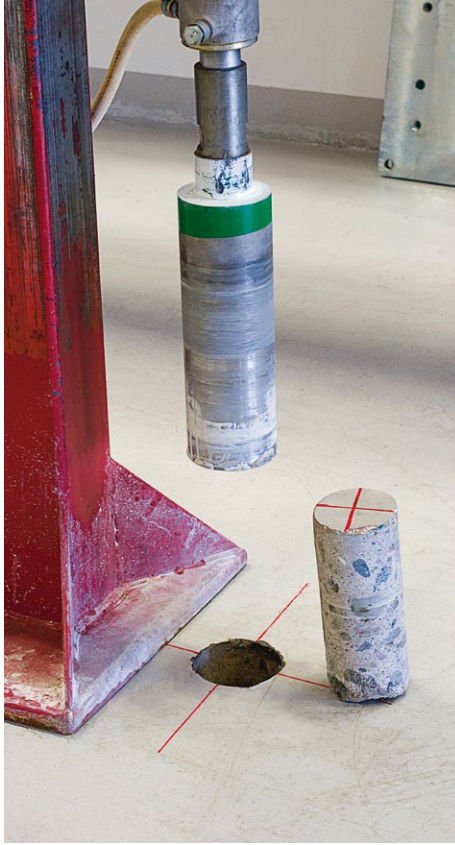

## Easy to install. Just as easy to move

JOSAM i-press can be installed in existing concrete floors with a thickness of at least 150 mm. Our recommendation is for the installation of at least 13 x 3 anchorings.

For the floor anchorings true-to-gauge holes need to be drilled into the concrete floor (for measurement specifications, refer to the illustration in this folder). In every hole, floor anchorings need to be installed (chain anchorings or screw anchorings).

The centre beam is installed by attaching it to the floor anchorings with bolts. The centre beam can be removed at any time by loosening the bolts. In every joint between the beams, a joint connector is to be used.

The JOSAM i-press is easy to move. The floor anchorings can be knocked out and the centre beam dismantled for installation in a new location.

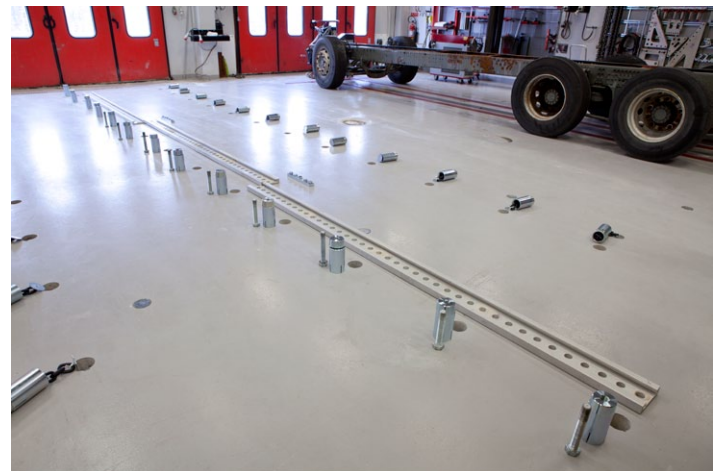



# Are you considering the possibility of beginning to do damage repairs on heavy vehicles?

## The JOSAM i-press makes it easy to get started!

The JOSAM i-press is an innovative and patent pending, universal straightening system developed by a world-leading supplier of straightening and wheel alignment equipment for heavy vehicles.

The JOSAM i-press is designed for straightening of vehicles with an U-shaped chassis beam. The straightening system is easy to use and quick to install on existing concrete floors in your workplace.

If you later want to make the floor space available for other jobs, dismantling the straightening system is just as easy and simple. One day a workplace for straightening of heavy vehicles, and the next morning the workplace is ready for another type of work.

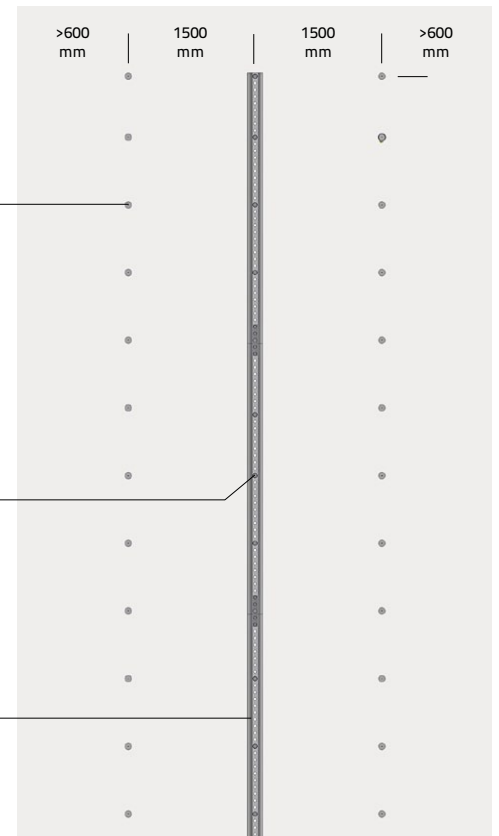
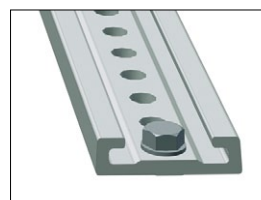

Representative:

Manufacturer:



# JOSAM®

Box 419 • SE-701 48 ÖREBRO • Sweden

Tel.: +46 19 30 40 00 • Fax +46 19 32 03 16

E-mail: [info@josam.se](mailto:info@josam.se) • Internet: [www.josam.se](http://www.josam.se)